

CamSemi - Controller Packing Options



A range of packing options

- By tape
- By reel

Overview

The C2470 series of controllers produce a novel way of off-line power conversion. They replace linear type power supplies with a low cost Switch-Mode solution Resonant Discontinuous Forward Converter (RDFC).

This new approach brings benefits over the current linear power supply solutions in a number of areas including high efficiency and the lowest EMI available in an SMPS solution

It is available in a SOT23-6 package.

The C2150 and C2160 controller families are the latest in **Primary Side Sensing (PSS)** controllers for quasi resonant flyback converters. As well as offering a reduced BOM count compared to standard flyback topologies, the controllers also offer benefits in meeting ENERGY STAR efficiency requirements, cable compensation, and in the case of the C2160 controller enables meeting new mobile phone five star no load requirements of <0.03W.

The controllers are available in SOT23-6 package.

Controller Packages



Figure 1: Left to right; SOT23-6 and SOP-8

For more information on packages, please go to

www.camsemi.com/support/packaging.htm

Packing Options

The two surface mount packages SOT23-6 and SOP-8 are available in tape and reel.

SOT23-6 Information

SOT23-6 Tape and Reel Information

Tape Width (mm)	Reel Size (inches)	No. of Parts	No. of Leader Pockets	No. of Trailer Pockets	Tape Option Indicator
8	7	3,000	100	100	TR7
8	13	10,000	100	100	TR13

SOT23-6 Orientation

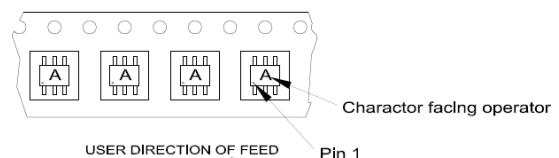

Figure 1: SOT23-6 Tape orientation

SOT23-6 Carrier Tape Information

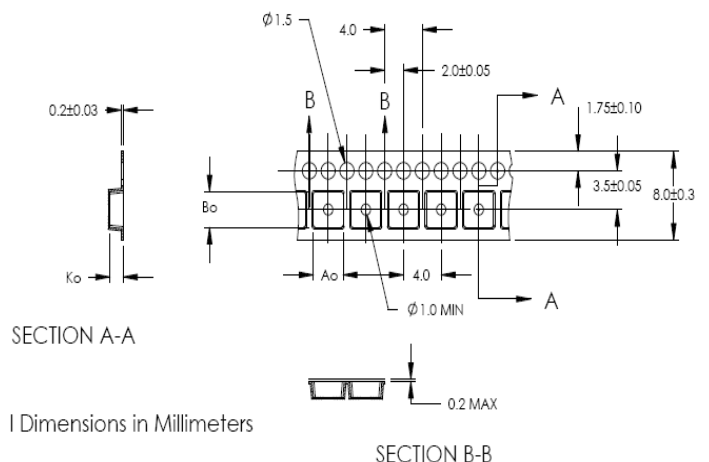

Figure 2: SOT23-6 Carrier Tape Information

SOP-8 Information

SOP-8 Tape and Reel Information

Tape Width (mm)	Reel Size (inches)	No. of Parts	No. of Leader Pockets	No. of Trailer Pockets	Tape Option Indicator
12	7	500	50	50	TR7
12	13	2,500	50	50	TR13

SOP-8 Orientation

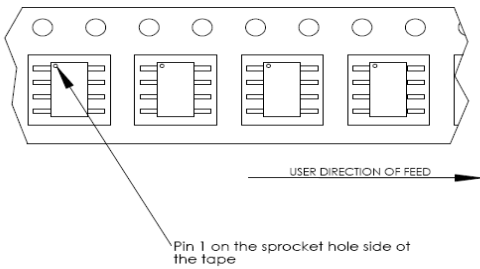

Figure 3: SOP-8 Tape orientation

SOP-8 Carrier Tape Information

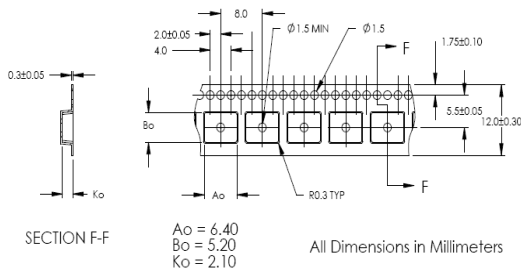

Figure 4: SOP-8 Carrier tape

SOT23-6 and SOP-8 Tape & Reel

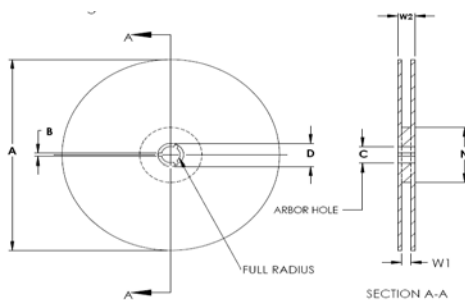

Figure 5: SOT23-6 and SOP-8 Tape and reel information

SOT23-6

Tape Option	A	B	C	D	N	W1	W2
TR7	179.0 ±1.0	1.5 min	13.0 ±0.5	20.2 min	55.0 ±0.5	8.4 to 9.9	14.4 max
TR13	330.0 ±4.0				100.0 ±2.0		

All measurements are in mm.

SOP-8

Tape Option	A	B	C	D	N	W1	W2
TR7	179.0 ±1.0	1.5 min	13.0 ±0.5	20.2 min	55.0 ±0.5	12.4 to 16.4	18.4 max
TR13	330.0 ±4.0				100.0 ±2.0		

All measurements are in mm.

Controller Series

The following controller options are available:

Part Number	Package	Family
C2471PX2	SOT23-6	RDFC
C2472PX2	SOT23-6	RDFC
C2151PX2	SOT23-6	PSS
C2152PX2	SOT23-6	PSS
C2161PX2	SOT23-6	PSS
C2162PX2	SOT23-6	PSS

For more Information

For details of our channel partners and information on future product, technology or corporate announcements, visit www.camsemi.com

Contact Information

European Design Centre

CamSemi
St Andrews House
St Andrews Road
Cambridge, CB4 1DL
United Kingdom

Tel: +44 1223 446450

Taiwan Design Centre

CamSemi
6F, No.58, Zhouzi St.,
Neihu District,
Taipei City 114,
Taiwan (R.O.C.)

Tel: +886 2 8178 1010

China Design Centre

Room 201, 2F
Shenzhen Academy of
Aerospace Technology,
Tower B, 10th Kejinan Rd.
Nanshan District,
Shenzhen, China 518057

Tel: +86 755 8611 7778

Korea Design Centre

No. 808 KOFOMO Tower,
16-2 Sunae-Dong, Bundang-GU,
Sungnam-Si, Kyunggi-Do,
463-825,
SOUTH KOREA

Tel: +82 31 711 1415